

Data sheet | Item number: 221-2502 **NEW**

Mounting carrier with strain relief; 2-way; for inline splicing connector with lever; for screw mounting; gray

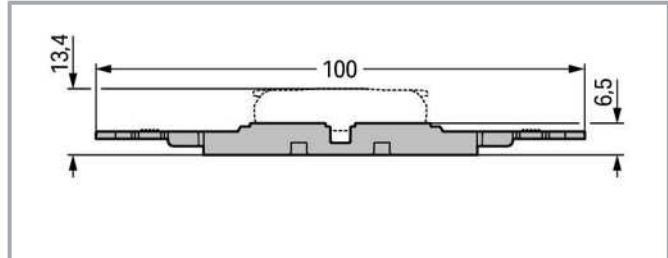

www.wago.com/221-2502

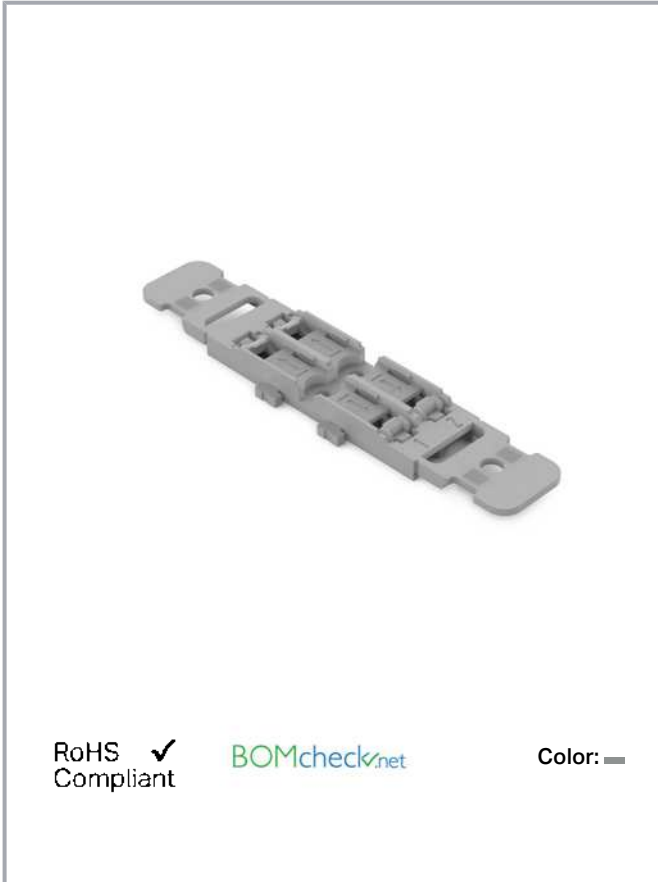

Subject to changes. Please also observe the further product documentation!

WAGO Corporation
Germantown, WI 53022
Phone: 1-800-DIN-RAIL (346-7245) | Fax: (262) 255-6222
Email: info.us@wago.com | Web: www.wago.us

Do you have any questions about our products?
We are always happy to take your call at {0}.

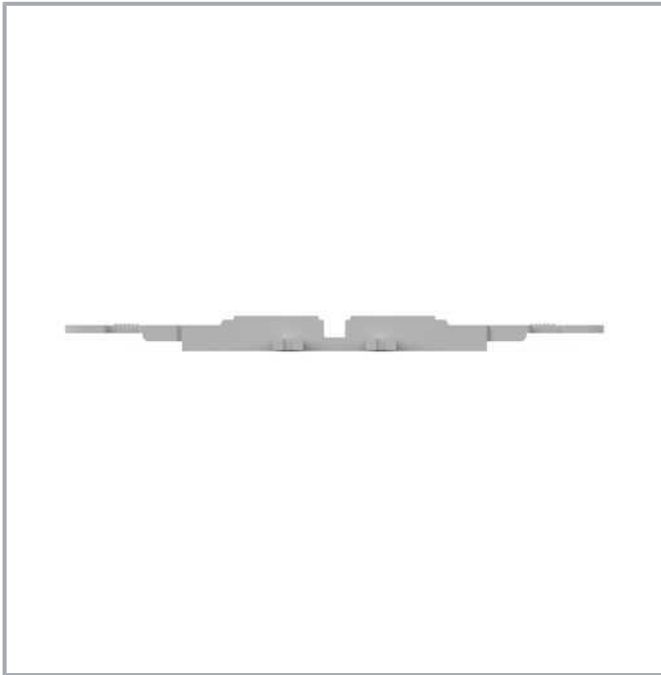

Data

Physical data

Width	20.8 mm / 0.819 inch
Height from the surface	6.5 mm / 0.256 inch
Depth	100 mm / 3.937 inch

Material data

Color	gray
Weight	4 g

Commercial data

Packaging type	BOX
Country of origin	CN
GTIN	4055144066753
Customs tariff number	3926909985

Compatible products

Marking accessories

Item no.: 210-334

Subject to changes. Please also observe the further product documentation!

WAGO Corporation
Germantown, WI 53022
Phone: 1-800-DIN-RAIL (346-7245) | Fax: (262) 255-6222
Email: info.us@wago.com | Web: www.wago.us

Do you have any questions about our products?
We are always happy to take your call at {0}.



 Marking strips; as a DIN A4 sheet; Strip width 5 mm; Strip length 182 mm; plain; Self-adhesive; white www.wago.com/210-334

assembling

 **Item no.: 209-119**
Fixing screw; for 209-120 mounting carrier www.wago.com/209-119

 **Item no.: 209-120**
Mounting foot; can be snapped on terminal blocks with snap-in mounting foot; for mounting on relay-modules; 6.4 mm wide; gray www.wago.com/209-120

 **Item no.: 209-123**
Mounting foot with screw; can be screwed on terminal blocks with fixing flange; 6.4 mm wide; gray www.wago.com/209-123

Downloads

Documentation

Additional Information

Technical explanations	2019 Apr 3	pdf 2.2 MB	Download
------------------------	------------	---------------	----------

Environmental Product Compliance

Compliance Search

Environmental Product Compliance 221-2502 Mounting carrier with strain relief; 2-way; for inline splicing connector with lever; for screw mounting; gray	URL	Download
---	-----	----------

Installation Notes

Subject to changes. Please also observe the further product documentation!