

Replacing the Locking Levers on the Smart Printer

Only authorized expert personnel are permitted to replace the locking levers – any mishandling voids the guarantee.

Locking lever (Item No. 258-**5022**)



Required tools:

Philips screwdriver
Pliers



ATTENTION: Risk of injury!

Protect yourself when working with tools!

Step 1:

Bottom housing: Unscrew the 3 cross-head screws with a Philips screwdriver and remove the bottom unit.

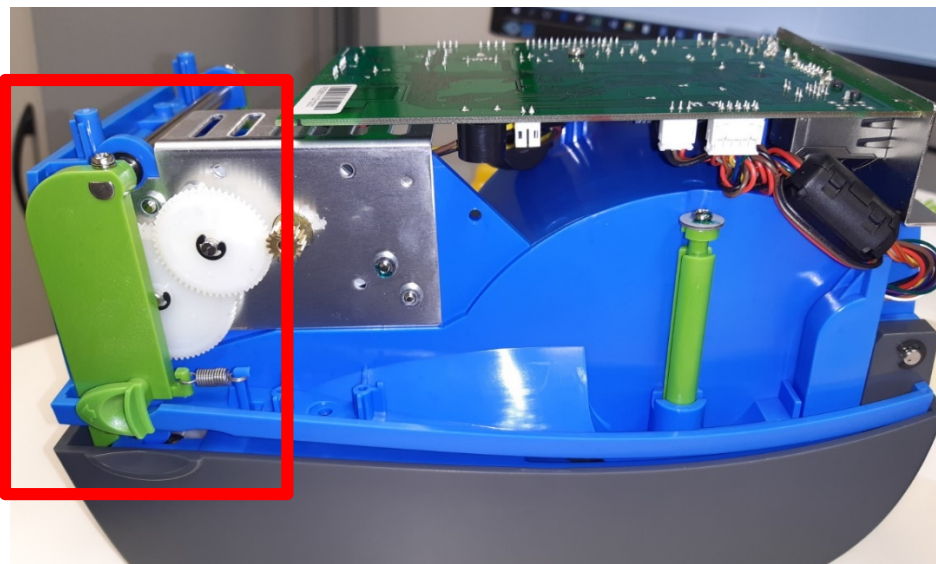

Step 2:

Place the printer on its side. The defective side is facing upward.

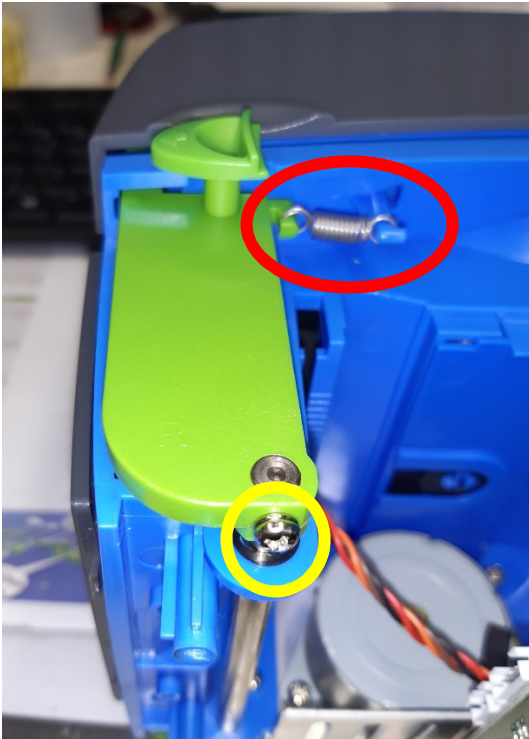

Red circle: Use pliers to remove the spring from the element.

Yellow circle: Unscrew the cross-head screw

Lightly shake the element while pulling it upward to detach it from the guide bar

Pull the element out toward the rear to remove it.

Step 3:

Dispose of the faulty element.

Install a new element in the reverse order as described above.

End of instructions.